

RoHS Compliant

REV	ECN No.	DATE	REMARK
A0	NEW	2019.11.21	NEW RELEASE

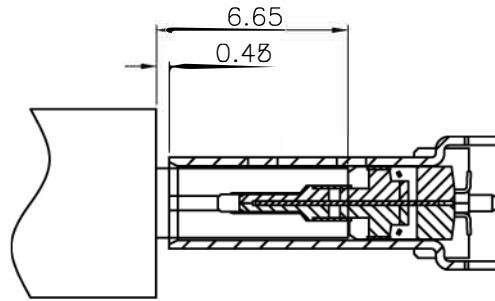
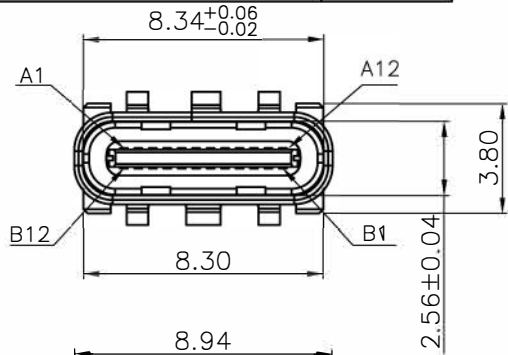

AFTER MATING

- NOTE:
- MATERIAL SPECIFICATION:
    - HOUSING: HIGH TEMPERATURE RESISTANT PLASTIC(LCP),UL94 V-0.
    - CONTACTS: COPPER ALLOY(C1814)T=0.12mm
    - MID PLATE: STAINLESS STEEL(SUS301)T=0.20mm
    - EMI PLATE: STAINLESS STEEL(SUS301)T=0.10mm
    - SHELL: STAINLESS STEEL(SUS304)T=0.30mm
  - PLATING SPECIFICATION:
    - CONTACTS:
      - Ni 50u" MIN. UNDER PLATED OVER ALL.
      - Au PLATED ON THE FUNCTIONAL AREA OF CONTACT.
      - (GOLD PLATING THICKNESS FOLLOW THE P/N)
      - PLATING SPECIFICATIONS OF THE SOLDER AREA FOLLOW THE P/N
    - FRONT SHELL&OUTER SHELL:
      - Ni 30u" MIN. UNDER PLATED OVER ALL.
    - MID PLATE:
      - CLEAR ONLY
    - EMI PLATE:
      - CLEAR ONLY
  - MECHANICAL PERFORMANCE,
    - INSERTION FORCE: 0.5~2.0kgf.
    - EXTRACTION FORCE: 0.8kgf~2.0kgf.
    - DURABILITY: 10000 CYCLES.
  - ELECTRICAL PERFORMANCE,
    - CURRENT RATING:5.0A  
VOLTAGE RATING:5.0V
    - LLCR:
      - VBUS & GND PINS AND OTHER PINS: 40mΩ/PIN MAX.
      - SHIELD: 50mΩ/MAX.
      - LLCR MAX. CHANGE OF ALL PINS: 10mΩ.
    - INSULATION RESISTANCE: 100MΩ MIN
    - DIELECTRIC WITHSTAND VOLTAGE,AC 100V FOR 1 MINUTE.
  - ENVIRONMENTAL PERFORMANCE:
    - OPERATING TEMPERATURE: -25°C~+85°C.
  - IR REFLOW:
    - THE PEAK TEMPERATURE ON THE BOARD SHALL BE MAINTAINED FOR 10 SECONDS AT 260°C.

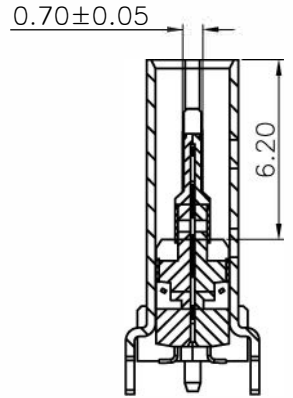
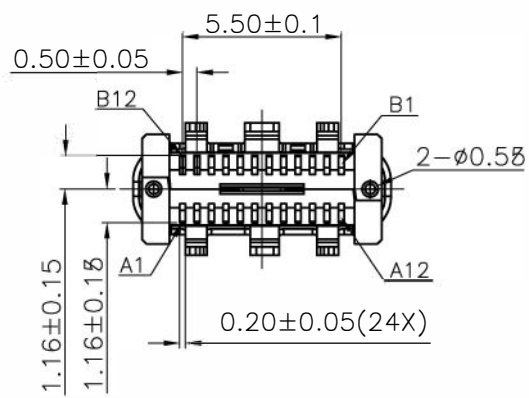
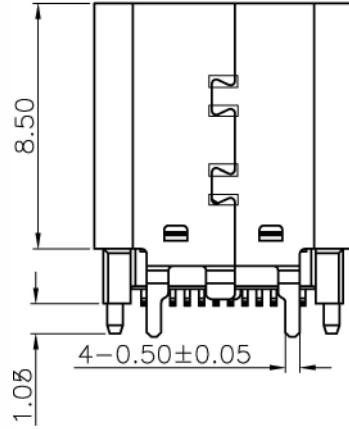
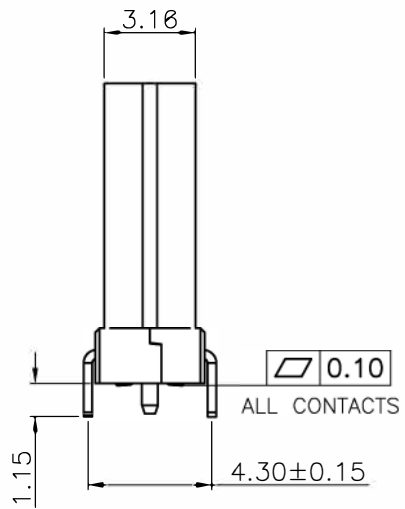
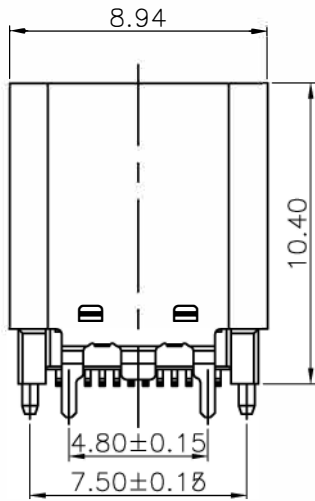

SECTION: A-A

7. PART NUMBER CODE:  
C F175 - 24 S L  $\begin{matrix} X \\ (1) \end{matrix}$   $\begin{matrix} XX \\ (2) \end{matrix}$  R - C3

(1) HOUSING COLOR: (2) CONTACTS PLATED:  
 B: BLACK                      02: 半金錫3u"  
 N: 本色                        04: 半金錫15u"  
    05: 半金錫30u"

PART NO.: SEE THE PART NUMBER CODE		GOLDCONN TECHNOLOGIES COMPANY LIMITED		DRAWN BY SAM	DATE 2019.11.21																
GENERAL TOLERANCES (UNLESS SPECIFIED)		TITLE USB 3.1 TYPE C FEMALE VERTICAL H10.4mm SMT TYPE一体成型		CHECKED BY JAY	DATE 2019.11.21																
QUALITY SYMBOL	0	<table border="1"> <tr><td>x.xxxxx</td><td>±</td><td>---</td></tr> <tr><td>x.xxx</td><td>±</td><td>0.10</td></tr> <tr><td>x.xx</td><td>±</td><td>0.25</td></tr> <tr><td>x.x</td><td>±</td><td>0.30</td></tr> <tr><td>ANGULAR</td><td>±</td><td>---</td></tr> </table>	x.xxxxx	±	---	x.xxx	±	0.10	x.xx	±	0.25	x.x	±	0.30	ANGULAR	±	---	DWG.NO. CF175-24-C3	SHEET NO. 1 OF 2	APPROVED BY JACKY	DATE 2019.11.21
x.xxxxx	±	---																			
x.xxx	±	0.10																			
x.xx	±	0.25																			
x.x	±	0.30																			
ANGULAR	±	---																			
		DIMENSION STYLE MM ONLY	DESIGN UNITS METRIC	SCALE 1:1	THIRD ANGLE PROJECTION																

frame size: A4

RoHS Compliant

REV	ECN No.	DATE	REMARK
A0	NEW	2019.11.21	NEW RELEASE

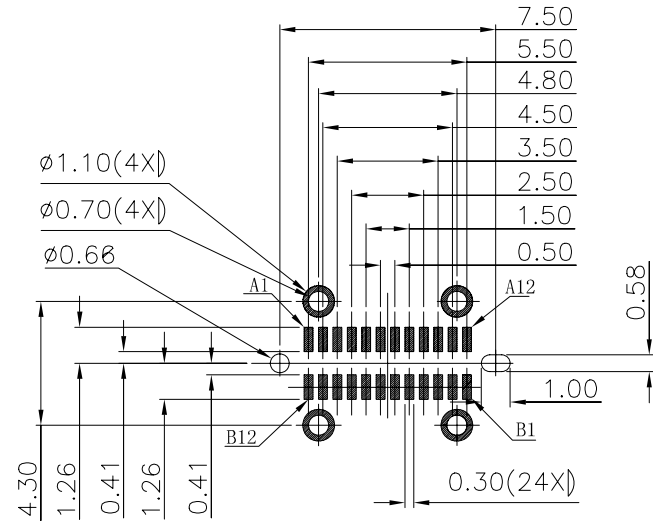
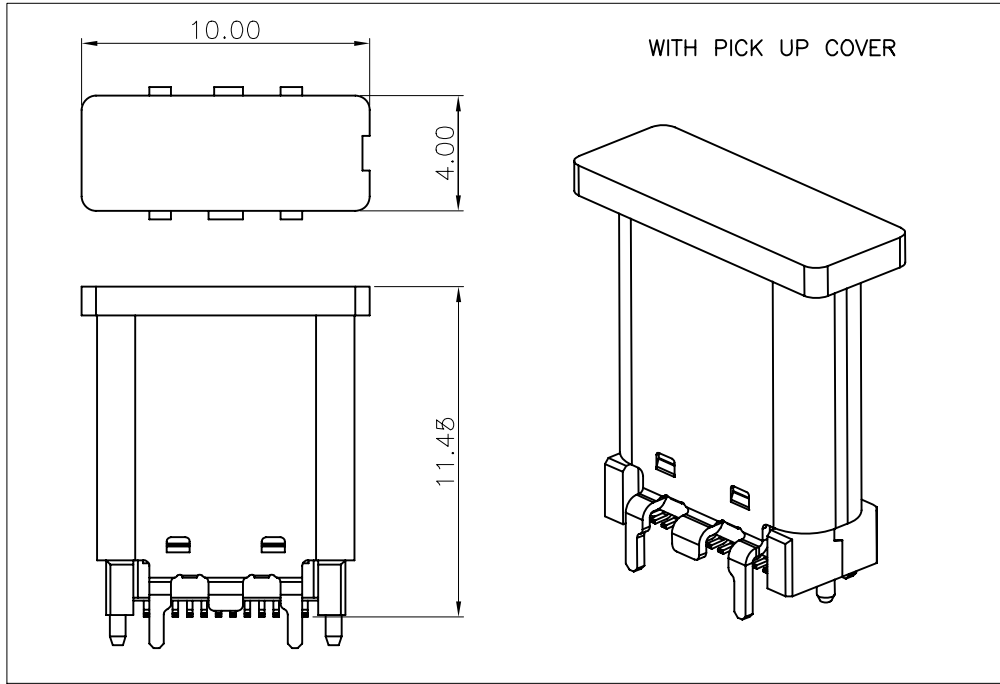

USB TYPE-C PIN ASSIGNMENTS

PIN NUMBER	SIGNAL NAME	PIN NUMBER	SIGNAL NAME
A1	GND	B12	GND
A2	SSTXp1	B11	SSRXp1
A3	SSTXn1	B10	SSRXn1
A4	Vbus	B9	Vbus
A5	CC1	B8	SBU2
A6	Dp1	B7	Dn2
A7	Dn1	B6	Dp2
A8	SBU1	B5	CC2
A9	Vbus	B4	Vbus
A10	SSRXn2	B3	SSTXn2
A11	SSRXp2	B2	SSTXp2
A12	GND	B1	GND

RECOMMENDED PCB LAYOUT(TOP VIEW)  
THICKNESS 1.5±0.10MM;DEFAULT TOLERANCE:±0.05

PART NO.: SEE THE PART NUMBER CODE		GOLDCONN TECHNOLOGIES COMPANY LIMITED		DRAWN BY SAM	DATE 2019.11.21	
QUALITY SYMBOL = 0 ▽ = 0 = 0 ▽ = 0	GENERAL TOLERANCES (UNLESS SPECIFIED)		TITLE USB 3.1 TYPE C FEMALE VERTICAL H10.4mm SMT TYPE一体成型			
	x.xxxx	± ---	DWG.NO. CF175-24-C3	SHEET NO. 2 OF 2	CHECKED BY JAY	DATE 2019.11.21
	x.xxx	± 0.10			APPROVED BY JACKY	DATE 2019.11.21
	x.xx	± 0.25	DIMENSION STYLE MM ONLY	DESIGN UNITS METRIC	SCALE 1:1	THIRD ANGLE PROJECTION
	x.x	± 0.30				
ANGULAR	± ---°					