

RECOMMENDED PCB LAYOUT (THICKNESS: 0.80MM)
P/W B TOLERANCE: ±0.05

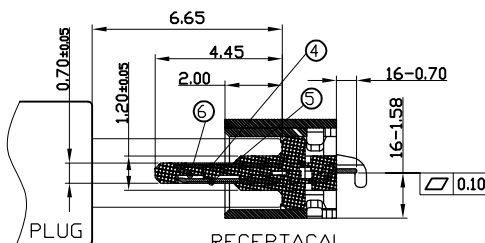
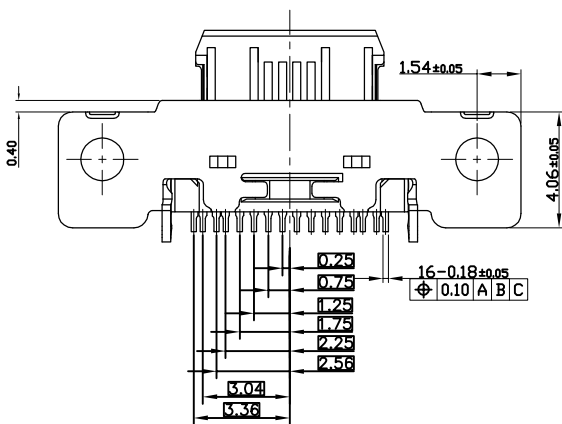
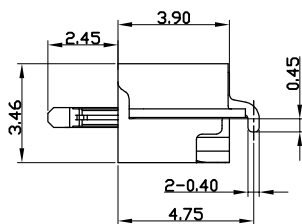
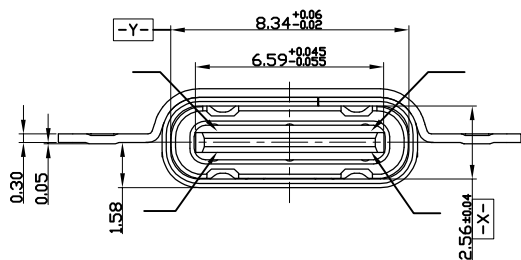

SPECIFICATION:

1. ELECTRICAL CHARACTERISTICS:

1.1 CURRENT RATING: 1.5A/ Pin MAX(A4,A9,B4,B9)
1.25A/ Pin MAX(A1,A12,B1,B12), 0.25A (OTHER PIN)

1.2 TEMPERATURE RANGE: -40 °C ~ 85 °C

1.3 CONTACT RESISTANCE: 30 MILLIONHM MAX.

1.4 DIELECTRIC WITHSTANDING VOLTAGE: 100 VAC r.m.s

1.5 INSULATION RESISTANCE: 100 MEGOHMS MIN.

2. MECHANICAL CHARACTERISTICS

2.1 INSERTION FORCE: 5~20N

2.2 EXTRACTION FORCE: Initial: 8~20N, AFTER TEST 6~20N

2.3 DURABILITY: 10,000 CYCLES

3. ENVIRONMENTAL CHARACTERISTICS

3.1 TEMPERATURE RANGE: -40 °C ~ 85 °C

3.2 IR REFLOW:
THE PEAK TEMPERATURE ON THE BOARD SHALL BE MAINTAINED FOR 10 SECONDS AT 260°C.

4. PART NUMBER CODE: (产品料号)

CF3 16 - 005 S X B XX R - F8
(1) (2) (3) (4) (5)

(1) Pin No.
16: 16PIN

(2) HOUSING MATERIAL:
NIPA46

(3) HOUSING COLOR:
B: BLACK

(4) CONTACTS PLATED:
12: 接触镀金 3u" 其它 GF

(5) PACKING OPTIONS
R: TAPE & REEL

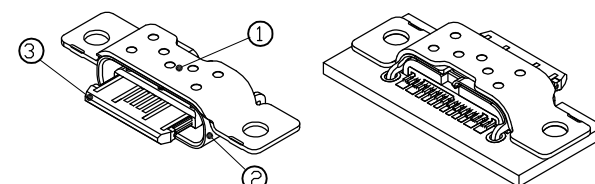

NO.	DESCRIPTION	QTY.	MATERIAL	FINISH
⑥	MID PLATE	1 PCS	STAINLESS STEEL	LN0 SURFACE TREATMENT
⑤	CONTACT B	1 SET	COPPER ALLOY	NI 50u" MIN. UNDER PLATED OVER ALL.
④	CONTACT A	1 SET	COPPER ALLOY	AU PLATED ON THE FUNCTIONAL AREA OF CONTACT. (GOLD PLATING THICKNESS FOLLOW THE P/N) PLATING SPECIFICATIONS OF THE SOLDER AREA FOLLOW THE P/N
③	HOUSING	3 PCS	NYLON 46	COLOR: BLACK
②	SHELL	1 PCS	STAINLESS STEEL	30u" MIN. UNDER PLATED OVER ALL.
①	COVER SHELL	1 PCS	STAINLESS STEEL	30u" MIN. UNDER PLATED OVER ALL.

QUALITY SYMBOL 	PART NO.: SEE THE PART NUMBER CODE		GOLDCONN TECHNOLOGIES COMPANY LIMITED		DRAWN BY SAM	DATE 2019-9-17
	GENERAL TOLERANCES (UNLESS SPECIFIED)		TITLE Type c母座 16P 沉板 1.58 舌片外露带耳		CHECKED BY JAY	DATE 2019-9-17
	x.xxxx	± ---	DWG. NO. CF316-005-F8	SHEET NO. 1 OF 1	APPROVED BY JACKY	DATE 2019-9-17
	x.xxx	± 0.10			DIMENSION STYLE MM ONLY	DESIGN UNITS METRIC

